

CLASSIC STEEL
21-11 X 34-10 TECH-J RIGHT

PART#: ISK-MJ-2235-24-STD	SURFACE AREA: (ft ²): 584	PERIMETER: 94'-1 1/4"
DATE: 01/01/07	LINER AREA (ft ²): 763	VOLUME (US Gal): 16,263
SCALE: 1/8" = 1'-0"	SFTY COVER AREA (ft ²): 881	VOLUME (Litres): 61,562



NON-DIVING POOL
 USE OF DIVING EQUIPMENT
 IS PROHIBITED

MEETS DEPTH AND SHAPE MINIMUM STANDARD ANS/SP15-2003



6' STEP

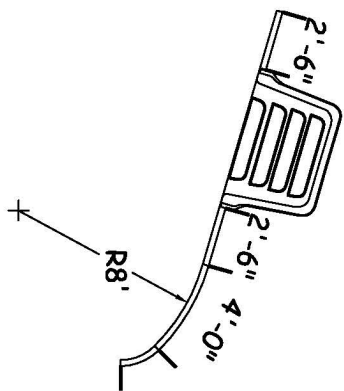

8' STEP

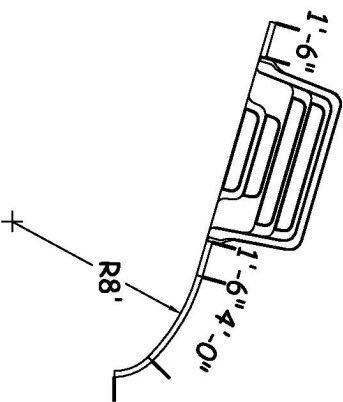

DWG#: **CLMJ24S22235R07**

SHEET: 1 OF 2

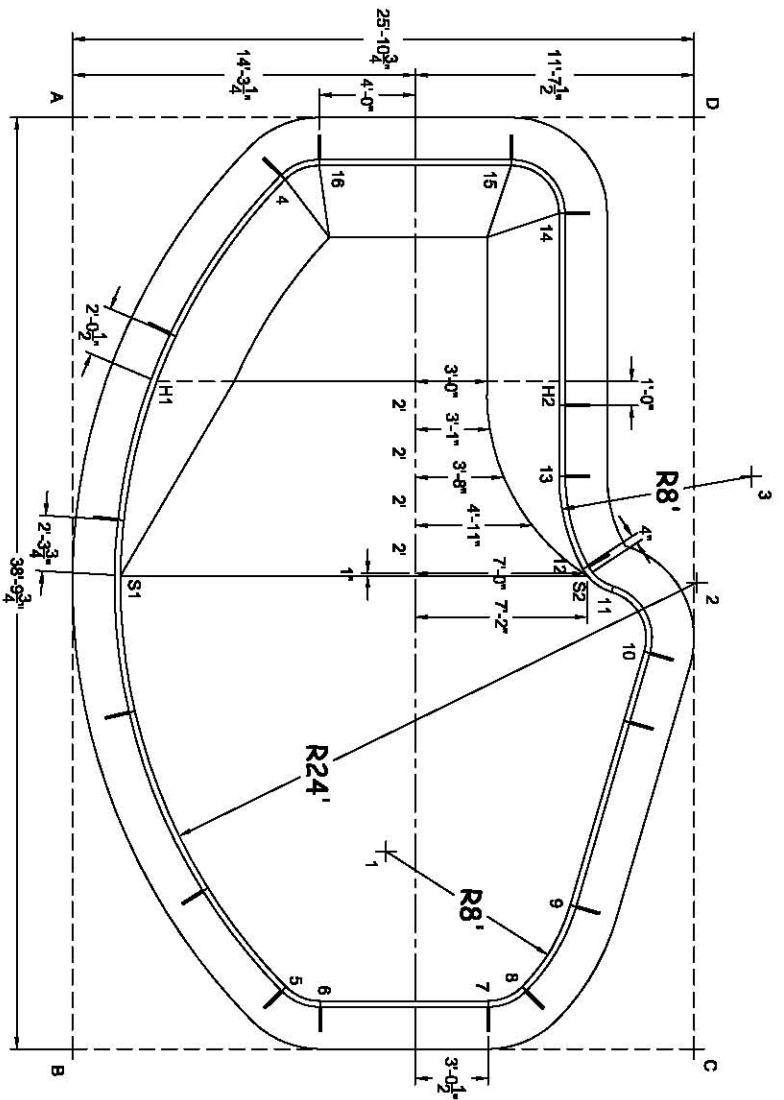

	A	B	C	D
1	33'-3"	15'-5 1/4"	15'-3"	33'-1 3/4"
2	32'-5 1/4"	32'-5 1/2"	19'-5"	19'-4 1/2"
3	31'-11 3/4"	36'-11 3/4"	23'-11 1/2"	15'-1 3/4"
4	9'-2 3/4"	37'-3 1/2"	40'-0 1/4"	17'-2 3/4"
5	37'-3 1/2"	9'-3 1/4"	17'-2 1/4"	40'-0"
6	38'-2 3/4"	10'-6"	15'-8 1/2"	39'-9 1/2"
7	40'-8"	17'-5"	8'-9 3/4"	37'-9 1/2"
8	40'-9 1/4"	18'-10 3/4"	7'-7 1/2"	36'-11"
9	38'-9 3/4"	21'-7"	7'-11"	33'-2 1/2"
10	32'-7"	29'-0"	16'-8 1/4"	22'-4"
11	29'-11"	29'-5 1/4"	19'-4 1/4"	20'-0 3/4"
12	28'-4 1/2"	29'-2 1/4"	20'-6 1/4"	19'-4 1/2"
13	25'-2 1/4"	31'-3 1/2"	24'-6"	15'-11 3/4"
14	20'-8"	40'-3 1/4"	35'-3"	6'-10 3/4"
15	18'-4 1/2"	41'-1"	37'-7"	7'-10 1/2"
16	10'-5 1/2"	38'-2 1/2"	39'-11 3/4"	15'-9"
S1	19'-2 1/4"	19'-9 3/4"	30'-11 3/4"	30'-7"
S2	28'-8 1/2"	29'-1 1/2"	20'-2 1/2"	19'-7 1/4"
H1	11'-6 1/2"	28'-0 1/4"	35'-8 1/4"	24'-11 1/4"
H2	23'-0 3/4"	34'-5"	28'-4 1/2"	12'-4 1/4"
A	-	38'-9 3/4"	46'-7 3/4"	25'-10 3/4"

DIAGONALS	
1 TO 2	17'-1 1/4"
1 TO 3	21'-9 1/2"
1 TO 4	28'-3 1/2"
1 TO S1	15'-11 1/4"
1 TO S2	14'-2 3/4"
1 TO H1	21'-9 1/4"
1 TO H2	20'-10 1/4"
2 TO 3	4'-11 3/4"
2 TO 4	24'-0"
2 TO S1	24'-0"
2 TO S2	4'-6 3/4"
2 TO H1	24'-0"
2 TO H2	10'-1 3/4"
3 TO 4	23'-0 1/4"
3 TO S1	26'-7"
3 TO S2	7'-11 3/4"
3 TO H1	25'-1"
3 TO H2	8'-11"
4 TO 5	33'-7 1/2"
4 TO 6	34'-3"
4 TO 7	35'-3"
4 TO 8	35'-0 1/2"
4 TO 9	32'-5 3/4"
4 TO 10	24'-8 1/2"
4 TO 11	21'-11"
4 TO 12	20'-5"
4 TO 13	16'-10"
4 TO 14	11'-6"
4 TO 15	9'-5 1/4"
4 TO 16	1'-6 1/4"
4 TO S1	17'-10 1/2"
4 TO S2	20'-9"
4 TO H1	9'-11 1/2"
4 TO H2	14'-2 1/4"
6 TO 8	8'-5 1/4"
6 TO 10	19'-10 1/4"
6 TO 12	21'-0 3/4"
6 TO 14	34'-3 1/2"
6 TO 16	34'-9 3/4"
6 TO S1	19'-6 3/4"
6 TO S2	20'-11"
6 TO H1	26'-8 1/4"
6 TO H2	27'-8"
7 TO 8	1'-6 1/4"
7 TO 10	15'-11 1/4"
7 TO 12	18'-5"
7 TO 14	32'-11 1/4"
7 TO 16	35'-6"
7 TO S1	23'-5"

DIAGONALS	
7 TO S2	18'-2 1/4"
7 TO H1	29'-3 1/4"
7 TO H2	25'-11 3/4"
8 TO 10	14'-10 1/2"
8 TO 12	17'-7"
8 TO 14	32'-3"
8 TO 16	35'-3"
8 TO S1	23'-11 1/4"
8 TO S2	17'-4 1/4"
8 TO H1	29'-5 1/2"
8 TO H2	25'-3 1/4"
13 TO 14	10'-11 1/2"
13 TO 15	13'-1 1/4"
13 TO 16	16'-4 1/2"
13 TO S1	16'-8 3/4"
13 TO S2	4'-3 1/2"
13 TO H1	17'-2 3/4"
13 TO H2	3'-11 1/2"
S1 TO S2	19'-5 1/4"
S1 TO H1	8'-2 3/4"
S1 TO H2	19'-11 3/4"
S2 TO H1	19'-8"
S2 TO H2	8'-2"
H1 TO H2	18'-9"

BILL OF MATERIALS	STEP		
DESCRIPTION	NO	6'	8'
8'-0" STRAIGHT - PLAN	2	1	1
8'-0" STRAIGHT - HR	1	1	1
7'-0" STRAIGHT - HR	1	1	1
3'-0" STRAIGHT - PLAN	2	1	1
2'-6" STRAIGHT - PLAN	-	2	-
1'-6" STRAIGHT - PLAN	-	-	2
8'-0" X 24'-0" RADIUS - H180SBOM	1	1	1
8'-0" X 24'-0" RADIUS - PLAN	3	3	3
5'-3" X 24'-0" RADIUS - PLAN	1	1	1
4'-0" X 8'-0" RADIUS - PLAN	1	1	1
4'-0" X 8'-0" REV RAD - PLAN	1	1	1
3'-2" X 2'-0" RADIUS 90° CORNER	2	2	2
1'-7" X 2'-0" RADIUS 45° CORNER	3	3	3
1'-7" X 2'-0" REV RAD 45° CORNER	1	1	1
A-FRAME	18	19	19
HARDWARE STRAIGHT 160 PACK	1	1	1
REBAR STAKE 18 IN. (25 PACK)	2	2	2
OPTIONAL DECK SUPPORT	37	36	36

21-11 X 34-10 TECH-J RIGHT

DWG #: CLMJ24S2235R07

DATE: 01/01/07

SHEET: 2 OF 2